

# Prima Heat Lamp

*How to replace the old style ceramic fixture with the new style.*



## Tools needed:

- Phillips screwdriver
- Wire cutters
- Wire stripper
- Pliers

## Follow these steps...



1. Remove the 4 screws holding the dome to the top of the lamp.



2. Remove 2 screws (circled above) holding socket to socket base.



3. a. Remove screws holding ringed wires on the socket base.  
b. Remove screws holding socket base to lamp insert.



4. Pull insert and base away from top of lamp.



5. Clip rings off with wire cutters. Use wire cutter for this step.



6. Use wire stripper to remove 1/2" of insulation from end of each wire.



7. Remove unattached male spade clip from the new socket.



8. With pliers, crimp male spade clip onto bare wire ends.

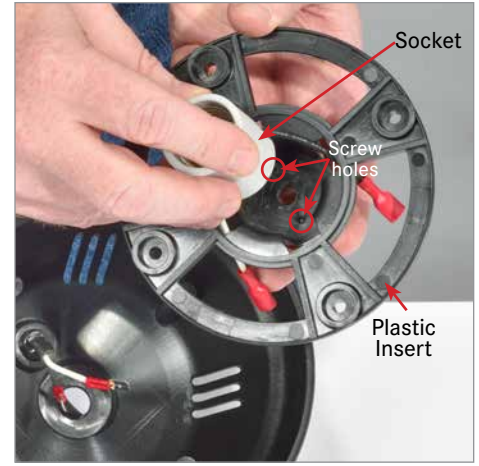

9. Place new socket into plastic insert. Line up screw holes of socket with those of lamp insert.



10. Screw socket to lamp insert.

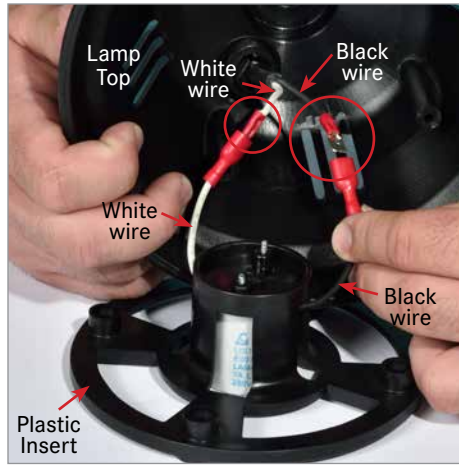

11. Attach white socket wire to white lamp wire via spade clips. Attach black socket wire to black lamp wire via spade clip.

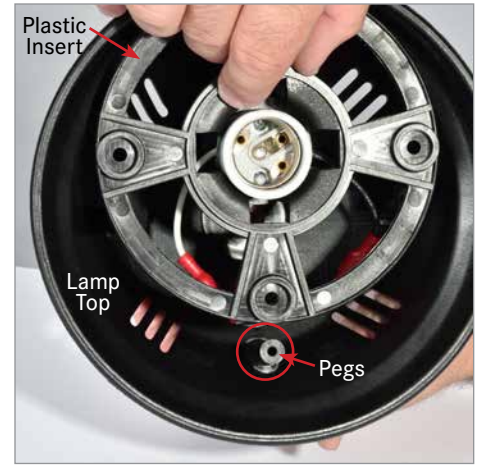

12. Place insert over pegs of lamp top.



13. Place lamp dome over insert. Line up holes of dome with those of insert.

Insert and tighten screws.  
You are now ready to use your heat lamp!



800-282-6631  
premier1supplies.com